



Military Construction:

Where We Are and Where We Are Going

22 January 2009



Agenda

- **FY2009 Military Construction Program Wrap-Up**
- **Bachelor Enlisted Quarters Initiative**
- **Grow the Force**
- **Military Construction Program Challenges**



Military Construction Program Totals

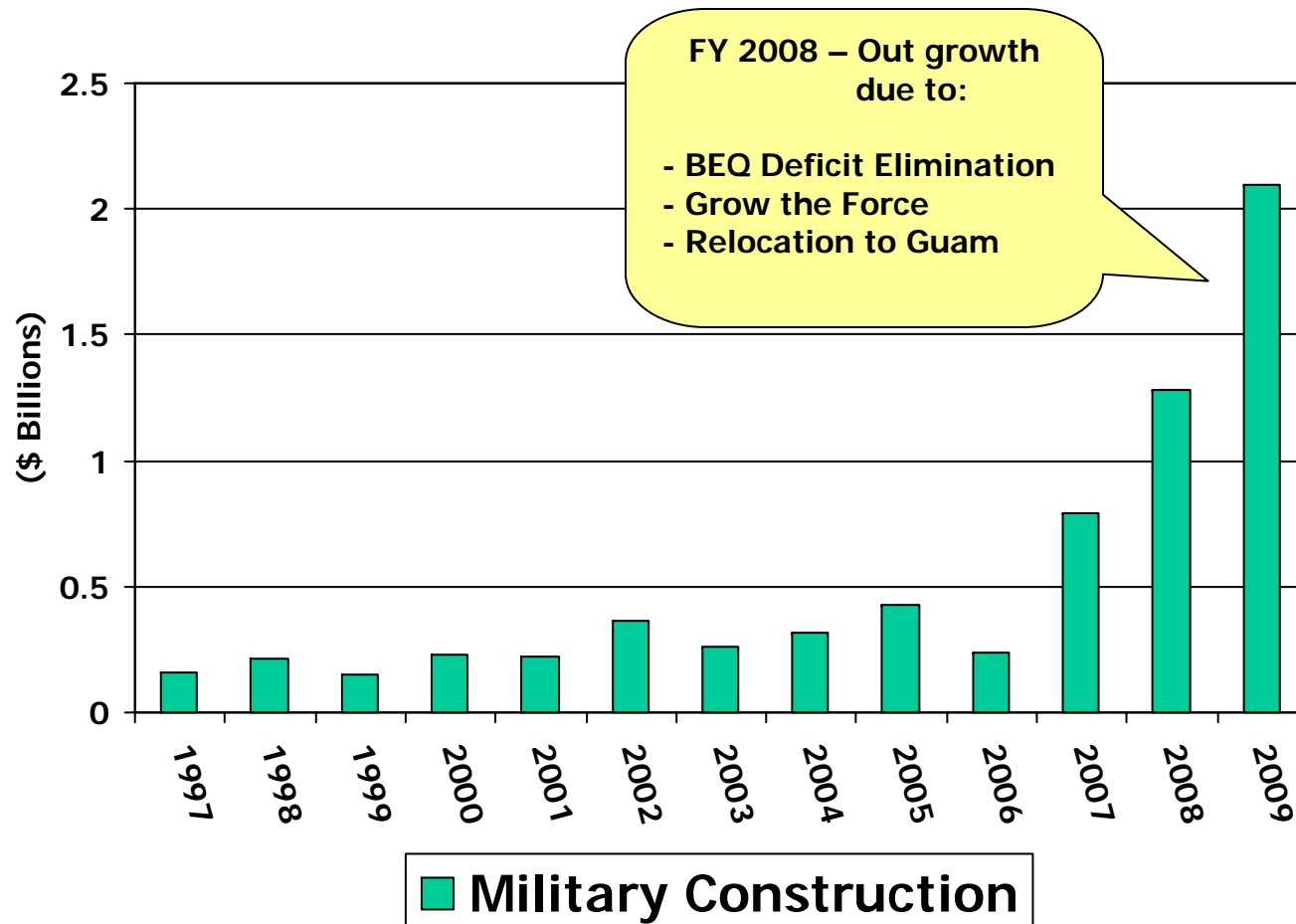



FY 2009 MILCON Program

- **FY 2009 MILCON Program = \$2.1B**
- **Program Focus:**

BEQ's	56%
Recruit Barracks/Student Officer	8%
Other Quality of Life	6%
Operations	6%
Training	9%
Maintenance	3%
Infrastructure	3%
Planning and Design	9%



Marine Corps Bachelor Housing Standards

- **Room Standard:**
 - 2+0 room configuration
 - Provides 180 NSF of living/sleeping area with bath and service area
- **Assignment Policy-**
 - E1-E3s assigned 2 per room with shared bath
 - E4-E5s assigned 1 per room with private bath

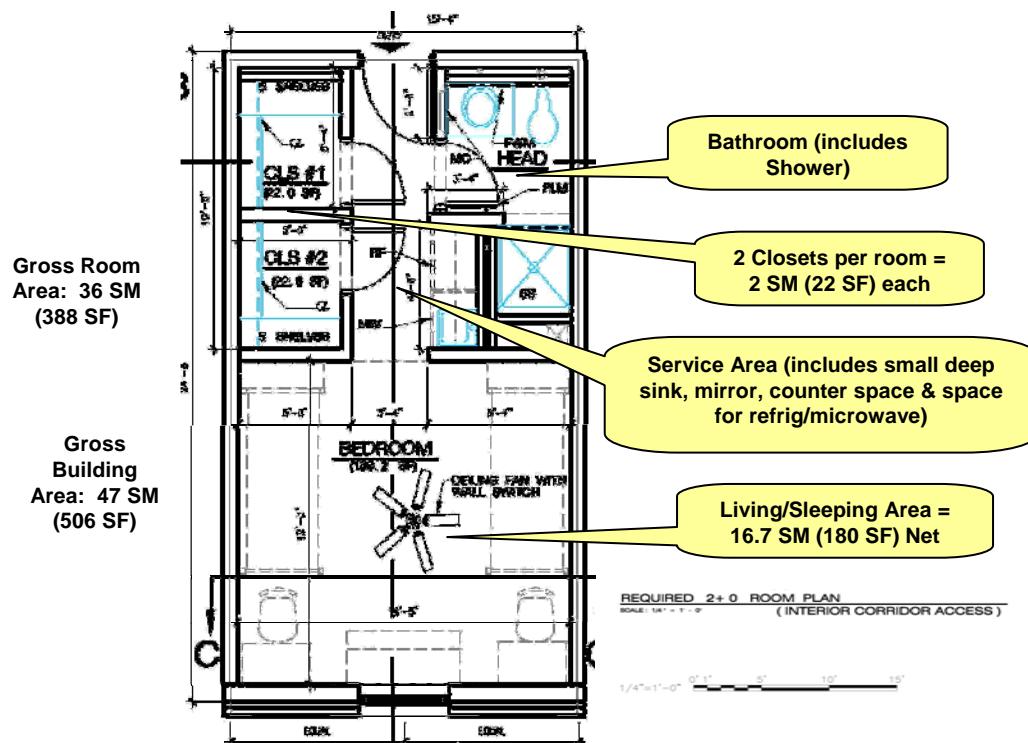



BEQ Initiative with Grow the Force Impact

Total Requirement = 101K Adequate Spaces

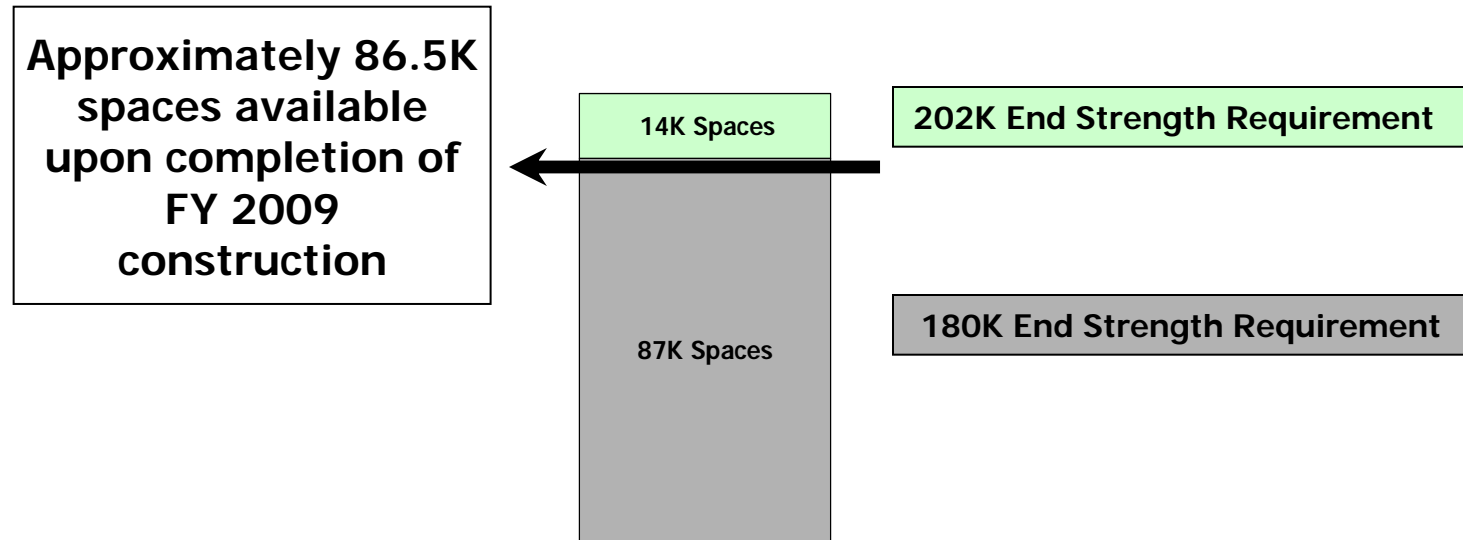

- Bachelor Enlisted Quarters –\$1.168B and 12,370 spaces are funded in FY 2009
- Grow the Force – Estimated requirement is approximately 14,000 additional spaces



Grow the Force Construction Plan

- **Facilities Plan**
 - Builds new permanent facilities no later than 2-4 years (average) after unit standup
 - Provides interim facility solutions coincident with unit standup until permanent facilities are funded and complete (average 2 – 4 years after unit standup)
- **Facility Requirements**
 - Unit specific operational and maintenance buildings
 - Family Housing and BEQ's
 - Community Support/Quality of Life
 - Ranges/Administrative/Training/Maintenance
 - Recruit Depot/School improvements



Grow the Force Interim Facilities Strategy

Operational

- Combination of:
 - Existing Spaces
 - Pre-Engineered Buildings
 - Sprung Structures
 - Trailers



Billeting

- Combination of:
 - Existing Spaces
 - Trailers
 - BAH





Military Construction Program Challenges

- **Many big initiatives concurrently being programmed:**
 - Grow the Force
 - BEQ's
 - Relocation to Guam
- **Rising costs of construction**
- **Workforce Availability**



Questions?